

INTRODUCTION

Thank you for purchasing the Plasma Cloud PSX8 Switch. This Quick Start Guide leads you through the installation process.

PACKAGE CONTENTS

- 1. Switch
- 2. AC cord*
- 3. Mounting brackets
- 4. Screws and anchors
- 5. Rubber feet set

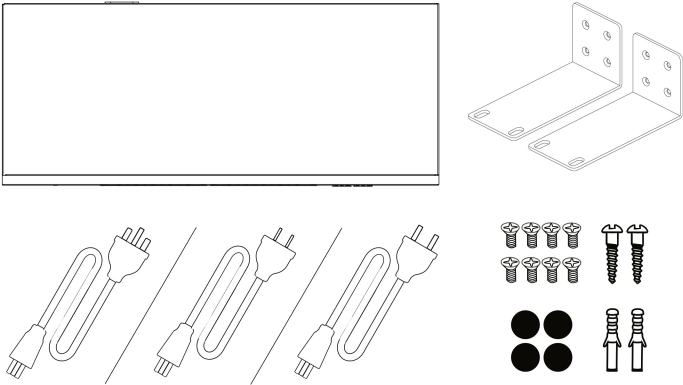

* The package contains either type A, C or G electrical outlet plug matching your region's power regulations.

CLOUD MANAGEMENT

- 1. Sign up at console.plasma-cloud.com.
- 2. Create your first organisation by navigating to **Organisations** → **Create new organisation**. Fill in the form and click **Create**.
- 3. You can now create your first network. Navigate to **Networks** → **Create new network**, fill in the form and click **Create**.
- 4. Setup your network by navigating to **Settings** → **Network**.
- 5. Go back to Overview and click on the map to add your first Switch.

The last point can be repeated to add as many Switches as needed.

You can now plug-in your Switch and connect it to the Internet. **The Plasma Cloud configuration only takes a few seconds!**

PHYSICAL INSTALLATION

The PSX8 Switch offers versatile mounting options, allowing installation on a desk, wall, or rack. It is intended for indoor use only.

When installing your Switch, keep the following in mind:

- Do not place heavy objects on the Switch.
- Don't place the Switch in direct sunlight and ensure there is sufficient space around the vents.
- Don't place the Switch next to a strong source of electromagnetic field.
- Ensure the power cord is properly plugged into the Switch and a power outlet with earthing connection, or equivalent.

SWITCH OVERVIEW

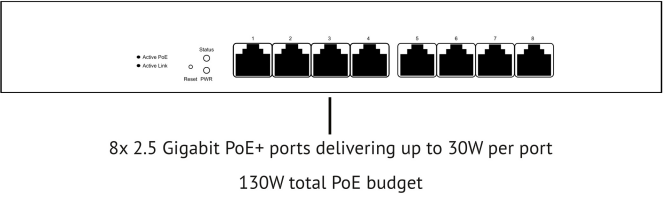

DESK OR SHELF MOUNTING

This Switch can be placed on a desk or a shelf:

- ① Stick the provided rubber feet to the four marks on the bottom of the Switch.
- ② Place the Switch on the desk or the shelf, making sure the surface is levelled.

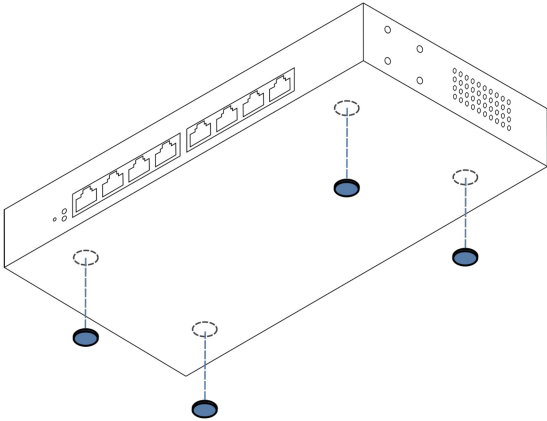

FCC EMC COMPLIANCE NOTICE

This equipment has been tested and found to comply with the limits for a Class A digital device, pursuant to part 15 of the FCC Rules. These limits are designed to provide reasonable protection against harmful interference when the equipment is operated in a commercial environment. This equipment generates, uses, and can radiate radio frequency energy and, if not installed and used in accordance with the instruction manual, may cause harmful interference to radio communications. Operation of this equipment in a residential area is likely to cause harmful interference in which case the user will be required to correct the interference at his own expense.

SUPPORT

For additional technical guidance or to contact our support, please visit support.plasma-cloud.com



PRODUCT PAGE

For more product details, please visit plasma-cloud.com/psx8

PRIVACY NOTES

For our customer privacy policy, please visit plasma-cloud.com/customer-policy



© 2025 Plasma Cloud Pte. Ltd. All Rights reserved
36 Carpenter Street, #02-01, Carpenter Haus, 059915 Singapore
www.plasma-cloud.com

The software included in this product contains copyrighted software that is licensed under GPL. A copy of that license, along with instructions on how to obtain the source code, is available at <https://www.gnu.org/copyleft/gpl.html>

WALL MOUNTING

This Switch can be mounted either vertically or horizontally to a wall:

- ① Attach the two mounting brackets to the sides of the Switch using the provided screws, as shown below.

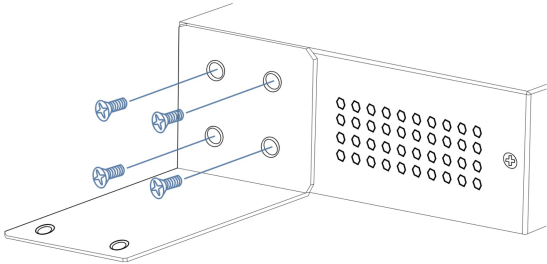

- ② Secure the mounting brackets to the wall using the provided screws and anchors, with the switch ports facing upward or sideways.

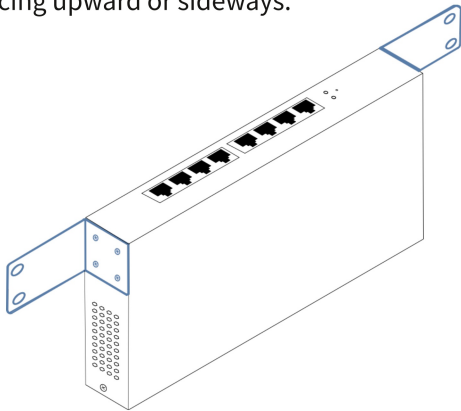

RACK MOUNTING

This Switch can be mounted in an EIA standard size (19") rack.

- ① Attach the two mounting brackets to the side of the Switch with the screws provided as shown below.

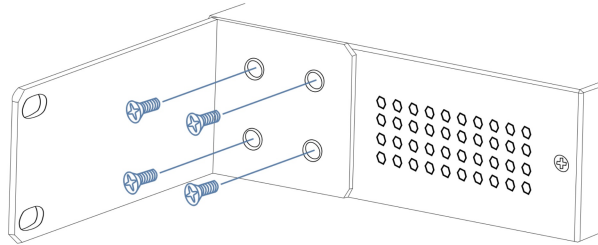

- ② Secure the mounting brackets to the rack using the provided screws, with the Switch ports facing forward.



PSX8

Quick Start Guide